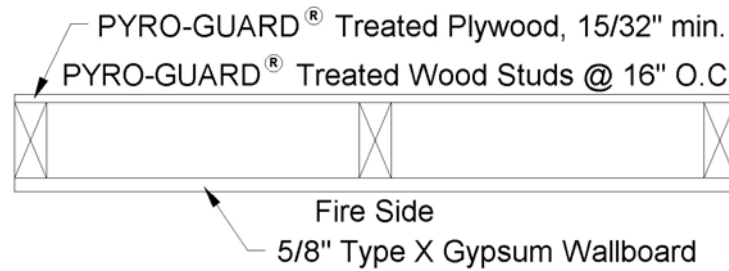

FIGURE 6: 1-HOUR FIRE-RESISTANCE RATED EXTERIOR WALL ASSEMBLY

Use where wall is required to be fire rated from the interior side only



INTERIOR SIDE: One layer ⁵/₈ inch type X gypsum wallboard or water resistant backer board or veneer base applied parallel with or at right angles to studs fastened with GWB-54 nails at 8 inches o.c. or 8 inches o.c. on the edges and double nailed in the field at 12 inches o.c. or 1 ¼ inch Type W drywall screws at 16 inches o.c.

STUD CAVITY: Insulation as described in IBC Table 722.6.2(5) is optional.

EXTERIOR SIDE: One layer of Pyro-Guard® treated plywood minimum 15/32 thickness category (Refer to Table 1) fastened in accordance with Table 2304.9.1 of the IBC covered with a water resistant barrier.

EXTERIOR FINISH: Material and thickness required by Table 1405.2 of the IBC installed in accordance with the manufacturers recommendations. Vinyl siding shall not be permitted with Type III or Type IV construction.